

HOW TO DONATE

“

Currently we don't have any other source of funding unless God opens his own ways - Sr. Pascalia (Matron)

”

You can make a donation in cash, by cheque or by bank transfer

If paying by cheque, please make it payable to:
Faith in Action - Turkwel.

If you wish to pay by bank transfer, the bank details are:

Faith in Action – Turkwel,
AIB, Western Rd., Cork
Account no. 23320035 **BIC** AIBKIE2D
Sort Code 934194
IBAN IE24 AIBK 9341 9423 3200 35

If paying by cash or by cheque, please place your donation in the envelope provided. You can return the envelope at any of the weekend Masses, or by post or by hand to the Parish Office, or to Fr. Bertie or to Fr. Tom.

If you would like a receipt, please complete the section below and return it with your donation.

For further information, please phone the Parish Office **(021-4344452)** or email **faithinactionballineaspaig@gmail.com**

Name: _____

Address: _____

Amount: _____

BIRTH - AND DEATH - IN THE DESERT



The nomadic Turkanas traverse the semi-arid lands of Northern Kenya in search of water and pasture for their animals. On a Sunday afternoon, the mission is called to one of these families living outside the village. A woman has given birth to a new baby – it has been a difficult birth, both mother and child are in urgent need of medical help. The family are distraught.

On an initial assessment the local nurse, whom we have brought with us, tells us the life of the child is in danger. After much discussion we convince the family to go to the local health centre for help. The family are prepared and we set out.

How we wish we could have reached them earlier or there was a health centre with maternity facilities nearby – unfortunately, it is going to be a long journey. As we reach the health centre the condition of the little baby has deteriorated and our worst fears are realized. The baby has passed away – the world seems a very unjust place - a life has been lost. We could have saved this life if we had the necessary maternity facilities.

- Fr Oliver Noonan, SMA

A Faith in Action Initiative - Ballineaspaig Parish, Cork.

Brochure generously sponsored by private donor.

Design and Printing on recycled paper by Snap,Cork.

**Can we come together
to build a Maternity Unit
in our sister parish,
Turkwel?**



Seamus Murphy, *Madonna and Child*

Target: €90,000

THE LOCATION



Kalemunyang in Turkwel Parish has a catchment area of about ten villages and is a centre for small trade and commerce. It is a transit place for many Turkanas who travel from north to south and east to west, as they migrate in search of grazing for their animals. Many of these people base themselves there for some months because of the availability of food and security.

The building of Kalemunyang dispensary in 2009, funded by Ballineaspaig parish, was a great milestone in providing adequate health care for the people. Ten years on and Kalemunyang is now a bigger village and with new medical needs. One of these is the most basic need of all - to provide a proper maternity ward for the safe arrival of newly-born babies where mothers receive proper attention and care.

*The maternity ward will provide **proper ante and post-natal care** for new mothers and babies, and **reduce deaths**.*

CURRENT SITUATION: THE FACTS



- **NO** Maternity Unit for catchment population of 9,352 as well as hundreds of migrants
- **NO** State Support
- **NO** specialist facilities but as many as 24 deliveries per month
- Only facility: an improvised delivery room in dispensary observation room
- Main hospital – 65 km away across the desert
- Mortality rate of Kenyan **mothers** – **75** times rate in Ireland
- Mortality rate of Kenyan **babies** – **10** times rate in Ireland

“ *It has been a challenge conducting deliveries without a maternity ward but with hope and your help we are looking forward to the realization of our dreams. It will be a great achievement for our community - Sr Pascalia (Matron)* ”

THE PLAN

6-bed Maternity Ward:

Reception
Labour Room
Delivery Room
Postnatal Ward
Shower Rooms
Toilets

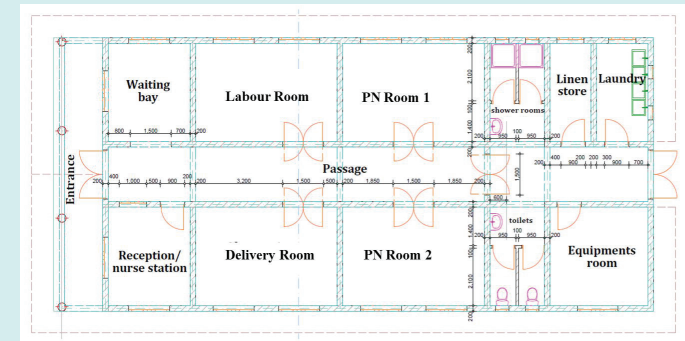

Maternity Equipment:

Suction machine
Incubator
Oxygen concentrator
Ambu bag
Baby cots
Baby weighing scales
Delivery packs
Ultrasound machine
Sterilizer